

A nighttime photograph of a city skyline, likely Hong Kong, with a network of glowing blue dots and lines overlaid across the scene, suggesting a smart city or IoT theme. The dots are of varying sizes and are connected by thin blue lines, creating a web-like pattern over the city lights and water.

siteco

SITECO Connect City

Deciding the future today.
Intelligent lighting control for
safety and nature conservation.

Intelligently
expand, control and
monitor city lighting:

with **SITECO**
Connect.



When does the future begin? Decide for yourself.

With us, you lay the foundation for a future-proof infrastructure. Thanks to Smart Interface, SITECO outdoor luminaires have standardized interfaces for the integration of radio-based control and sensors via plug & play. And SITECO Connect provides the suitable function packages for this.

When and to what extent you use these options for greater efficiency, networking and sustainability is entirely up to you. Either directly from installation, or upgrade flexibly when you feel the time is right. Your light is ready.

From simple control of individual luminaires to fully networked systems.

- **100% compatibility** between luminaire, control and sensor technology
- **100% freedom of choice** thanks to standardized interfaces (Zhaga Book 18 & D4i or NEMA)
- **100% future-proof** thanks to expansion options in case of later need
- **100% flexibility** in application – from simple to fully networked
- **100% convenience** thanks to plug & play of radio control systems and sensors

Intelligently
expand, control and
monitor city lighting:
**with SITECO
Connect.**

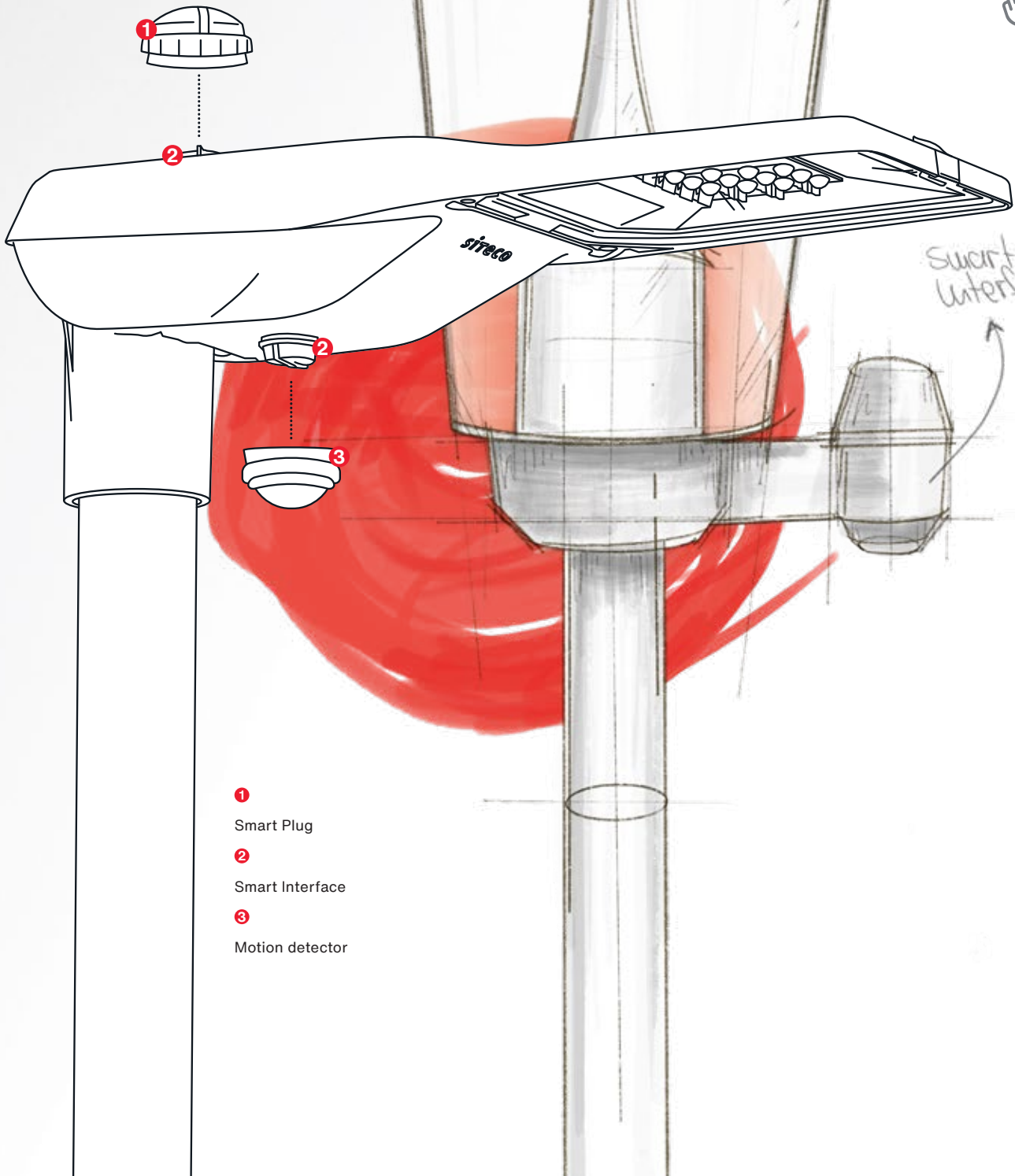

- 1 Smart Plug
- 2 Smart Interface
- 3 Motion detector

Smart
Interface



Adapt the lighting

In locations with changing usage, e.g. town squares and marketplaces, the lighting can be **automatically dimmed up and down**, for example during events.



Increase safety

Adjusted lighting levels make critical neighborhoods and streets safer.

Good visibility is also required for rescue operations. Brighter means safer.

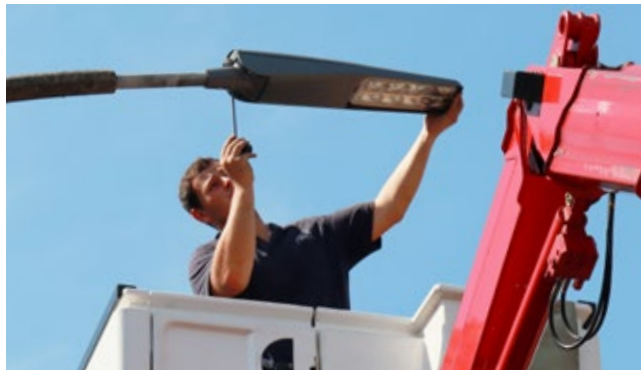

Optimize operation

Central documentation, switching, monitoring and diagnostics of the system **saves costs** and enables the **targeted planning of maintenance** if required.

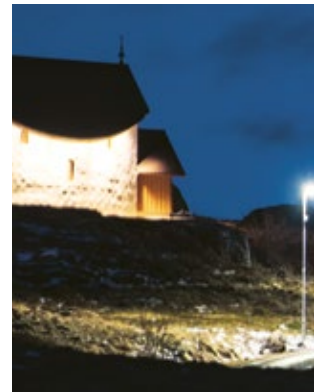

With SITECO Connect, everyone benefits.

Save up to 80 percent energy. Reduce CO₂ consumption. Transparently monitor the condition of the installation. Increase safety for the population. And do something good for the plant and animal world.

That sounds almost too good to be true, but only almost. Because time-based and situational lighting control via SITECO Connect provides communities, towns, cities and companies with impressive usage options that ultimately result in one thing: a lighting solution that benefits everyone.

Protect the climate

Where there is little activity at night, e.g. on rural roads, it is very easy to purposefully reduce illuminance levels. This has a direct impact on the **CO₂ balance**.



Reduce costs

Specific dimming and temporary deactivation of the lighting at suitable locations saves **valuable energy** and **increases the service life** of the luminaire.



Design for tourism

Landmarks and architecture worth seeing determine the character of a town or city. These attractions can be automatically illuminated and create a **pleasant atmosphere**.

Protect plant and animal life

Targeted dimming in the dark of night **reduces light pollution**. Nocturnal animals, particularly in parks and nature reserves, are less disturbed in their natural behavior.



Apply for funding

Modern lighting control makes it easier to implement **environmental guidelines**. This is the precise precondition when applying for **subsidies**.



Reduce vandalism

Vandals remain undetected in the dark. **Motion detectors** **protect** municipal institutions, sports facilities and schoolyards.

SITECO
Connect:
Now live.



Start off simply, upgrade flexibly.

100% flexibility through upgrades and downgrades

SITECO Connect 31: **Single luminaire**

Single luminaires are activated or dimmed with a local motion detector.



Example: The motion detector activates just one luminaire.

SITECO Connect 21: **Several luminaires connected locally**

Several luminaires are connected via radio.

The luminaires in the network communicate and synchronize with one another.

The luminaires are synchronously or continuously activated or dimmed.



Example: The motion detector also switches neighboring luminaires via radio link.

SITECO Connect 11: **Several luminaires connected with remote access**

The luminaires are connected via radio.

Settings can be defined from the office via the network with remote access and status messages sent automatically.

Existing inventory and workflow systems such as LuxData by sixData can be used as a master.



Example: The network of luminaires functions synchronously and is remotely monitored.

Light in motion makes a difference.

As if by magic, light switches on and accompanies vehicles, cyclists and pedestrians. Whether running or pre-running light, the key is motion detectors. These dim or switch the lighting, exchange information via radio and regulate brightness in the traffic tone. This not only increases safety on the road, but also reduces costs and protects the environment.

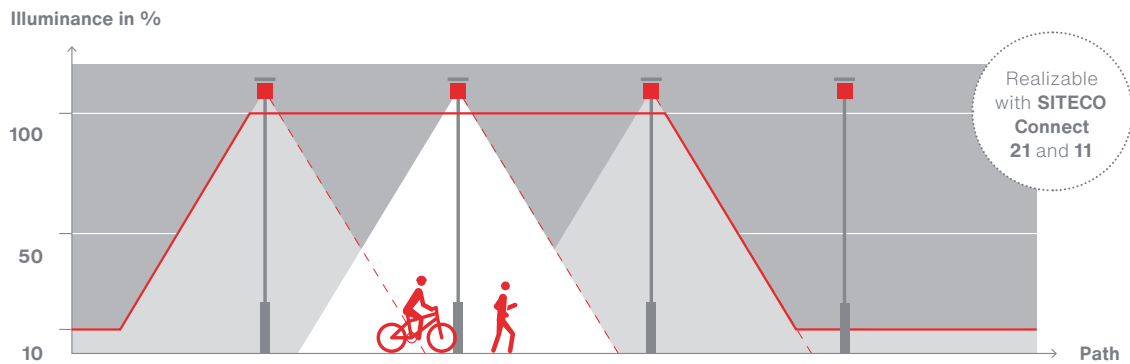

Situational light supports safety, environmental protection and cost efficiency.





1

Streetlight SL 11**Undisputably the top model – the luminaire of the future.**

A modern design with outstanding light for maximum visual comfort due to HD reflector technology. Highly efficient performance with reliable operation and intelligent control. The SL 11 leads the way.

2

Streetlight SL 21**The backbone of the modern city.**

With its smart, future-proof product concept, this all-rounder serves all urban applications ranging from bike paths to multi-lane arterial roads.

1

2

Our **technical** outdoor luminaires – “Smart City Ready”.



3

Streetlight SL 31

The cost-effective variant – practical and efficient.

Spend less for better light: The SL 31 provides demand-oriented, long-lasting street lighting and is ideal for the pragmatic refurbishment of old installations.

3

Our decorative outdoor luminaires – “Smart City Ready”.



1

DL® 30

A fresh look for urban spaces.

Decorative with visual guidance along the course of the road. Efficient with highly accurate light distributions. A pioneering luminaire with all control options.

2

DL® 50

The perfectly styled family of luminaires.

As a mast or catenary luminaire with a wide range of variants and a modular design, it combines technical and decorative light – precise and glare-free.

3

Bell

The classic, newly interpreted with LED.

A proven form meets innovative inner life including smart operating electronics. Available as a complete luminaire in two sizes and LED module for refurbishment applications.

4

Urban luminaires with Module 540

Modular on the path to the future.

A single module for many applications, efficient and elegant. The special optic with decorative light guidance achieves premium visual comfort and creates atmosphere.



SITECO
Connect:
Now live.

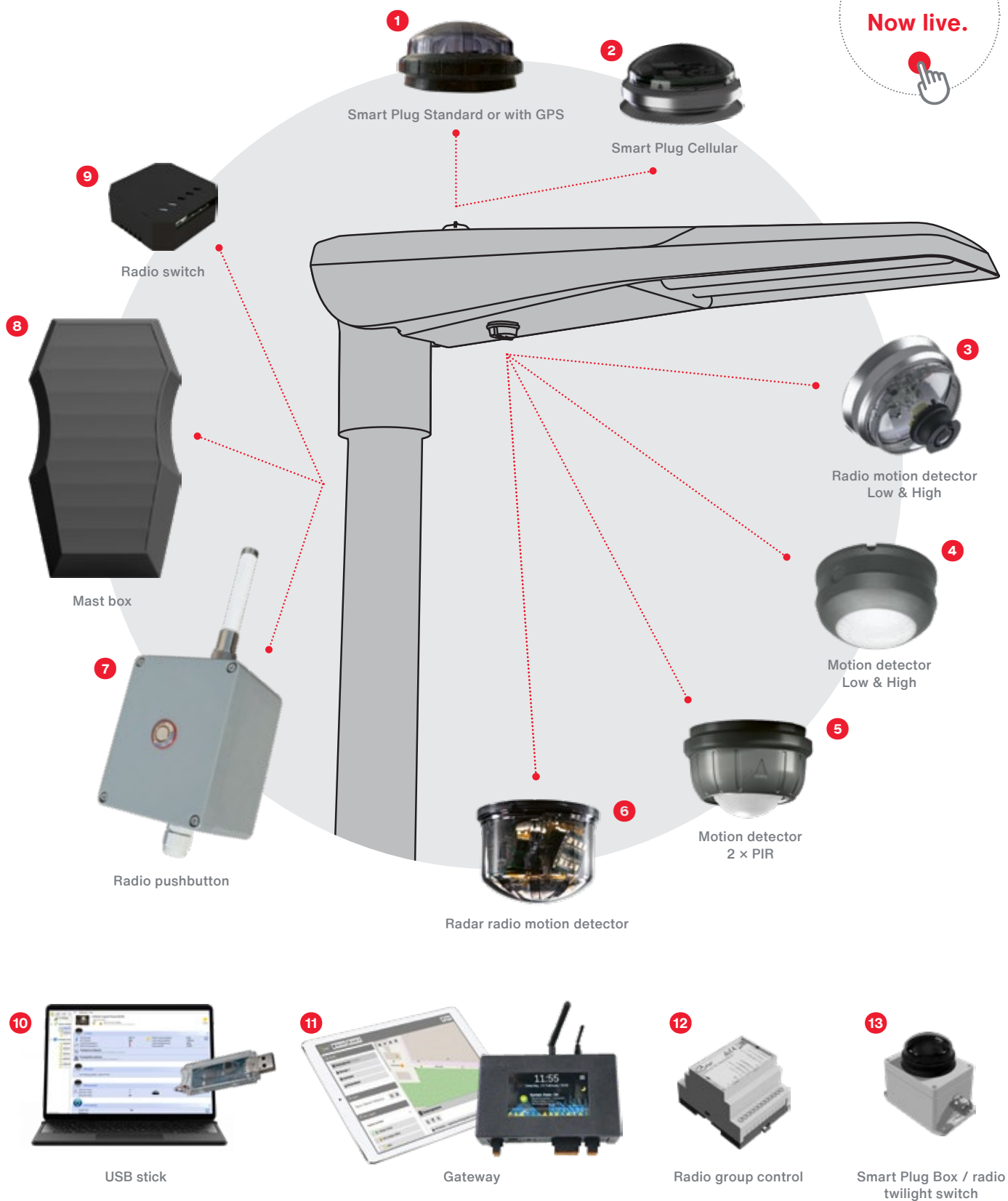

Smart Plugs

Control and radio networking of luminaires with Zhaga/D4i compatible luminaire controllers. With remote access or as a purely local radio network. Local storage of the switching and dimming calendar for reliable operation.

1 Smart Plug Standard	5EA3AM000001
1 Smart Plug GPS, radio clock and position detection	5EA3PM000001
2 Smart Plug Cellular: Control and remote access via the cellular network	5EA3CM000001
Extension of mobile communications term, 5 years	5EA1ES01

Motion detectors

Lighting control depending on movement, daylight, day of the week and time. Autonomous or networked operation (swarm function). Multiple setting options for dimming level, follow-up time, up/down speed.

Radio motion detector Low & High

Oval detection range, freely alignable, e.g. for paths and driveways. Radio controller (Smart Plug) integrated.

3 Low, mounting height below 6m	5EA40EL01
3 High, mounting height above 6m	5EA40EH01

Motion detector Low & High

Circular detection range, can be limited with cap, e.g. for surfaces.

4 Low, mounting height below 4.60m	5EA40LL01
4 High, mounting height above 4.60m	5EA40LH01

Motion detector 2 x PIR

Long detection range to the right and left of the luminaire, e.g. for residential streets.

5 Motion detector 2 x PIR	5EA40M000201
---------------------------	--------------

Radar radio motion detector

Very wide detection range to the right and left of the luminaire, e.g. for roads. Radio controller (Smart Plug) integrated.

6 Radar radio motion detector	5EA40RC01
-------------------------------	-----------

Radio pushbutton

Radio pushbutton for individual lighting scenes, e.g. manual switching for rescue operations.

7 Radio pushbutton	5EA30A000D01
--------------------	--------------

Mast boxes

Mast box for the control and networking of DALI luminaires without Smart Interface. With remote access or as a purely local radio network. Local storage of the switching and dimming calendar for reliable operation.

8 Standard mast box	5EA3BS01
8 GPS mast box	5EA3BG01
pre-assembled cable	5EA3BC01

Radio switch

Radio control for automatic on/off switching of electrical consumers such as spotlights, floodlights, Christmas lighting, pumps, etc.

9 Radio switch	5EA30A000S01
----------------	--------------

Setting and operation

Radio USB stick with software

For setting and checking of lighting control devices on site.

10 SL configurator with USB stick	5EAU0A000001
-----------------------------------	--------------

Radio gateway with web application

For remote setting and monitoring of lighting control devices.

Monthly usage fee for SL Control	5EA1KA000001
11 Gateway	5EAA00010003
Weatherproof housing	5EA51E002

Radio group control / radio ripple control for control cabinets

Radio control for control cabinets for wirelessly controlling groups of luminaires. 2 relay outputs for connection to contactor or control wire. Remote access via mobile radio. 5 years mobile communications usage included. Integration of further sensors such as twilight switches or weather sensors possible.

12 Radio group control	5EA1EC01
Unlimited term, extendable by 5 years in each case	5EA1ES01
13 Smart Plug Box Cellular	5EA3BH01
13 Twilight switch	5EA3BH01

Services

SITECO is happy to assist you with the planning and commissioning of your individual SITECO Connect system.

System configuration

Basic configuration per system or construction stage, remotely or on-site.

System configuration	5EA0DEA01
----------------------	-----------

End device configuration

Configuration per end device, remotely or on-site.

End device configuration	5EA0DEE01
--------------------------	-----------

Training

Software training and system training for up to 3 participants, 1.5 hours, via video conference or on-site.

Training	5EA0DES01
----------	-----------

On-site service

On-site support from the Siteco service team.

per kilometer driven	5EA0DER01
----------------------	-----------

The roundabout that thinks for itself.

Ideal combination of nature conservation and safety

- On-demand lighting usage for an illuminated roundabout in the countryside
- No traffic: Idle state with 15% light level
- Vehicle detected at 70 m distance: Increase to 100% lighting level
- Small animal filter blocks out detection of birds, squirrels, etc.
- Reduction of light pollution and reduced disturbance of nocturnal flora and fauna
- High safety for road users with reduced energy consumption
- Switching/dimming scenarios individually adjustable and manually switchable

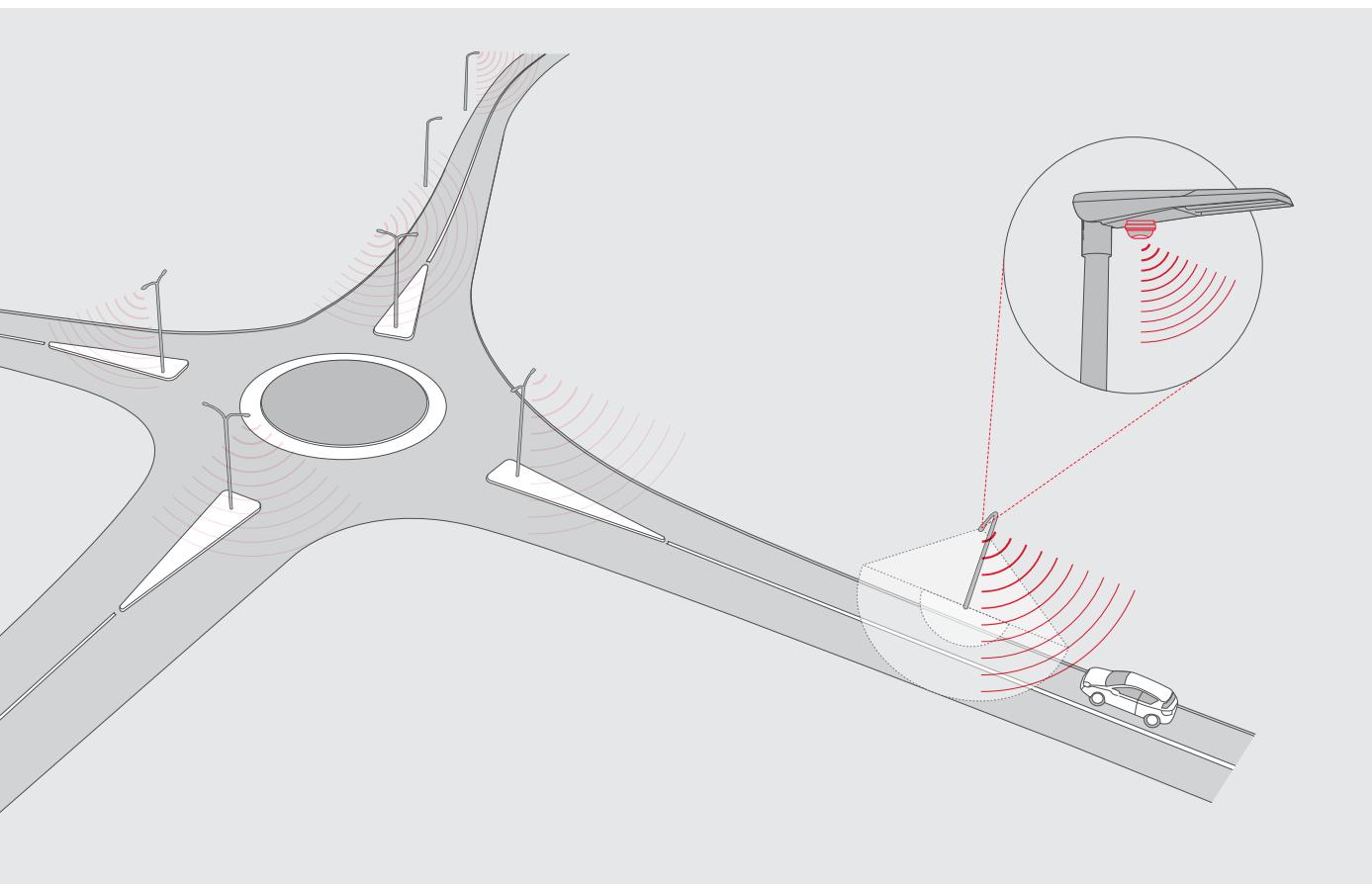

Project: Roundabout, municipality of Aschbach, Austria
Our solution: Streetlight SL21 / SITECO Connect 21
including radio networked motion sensors



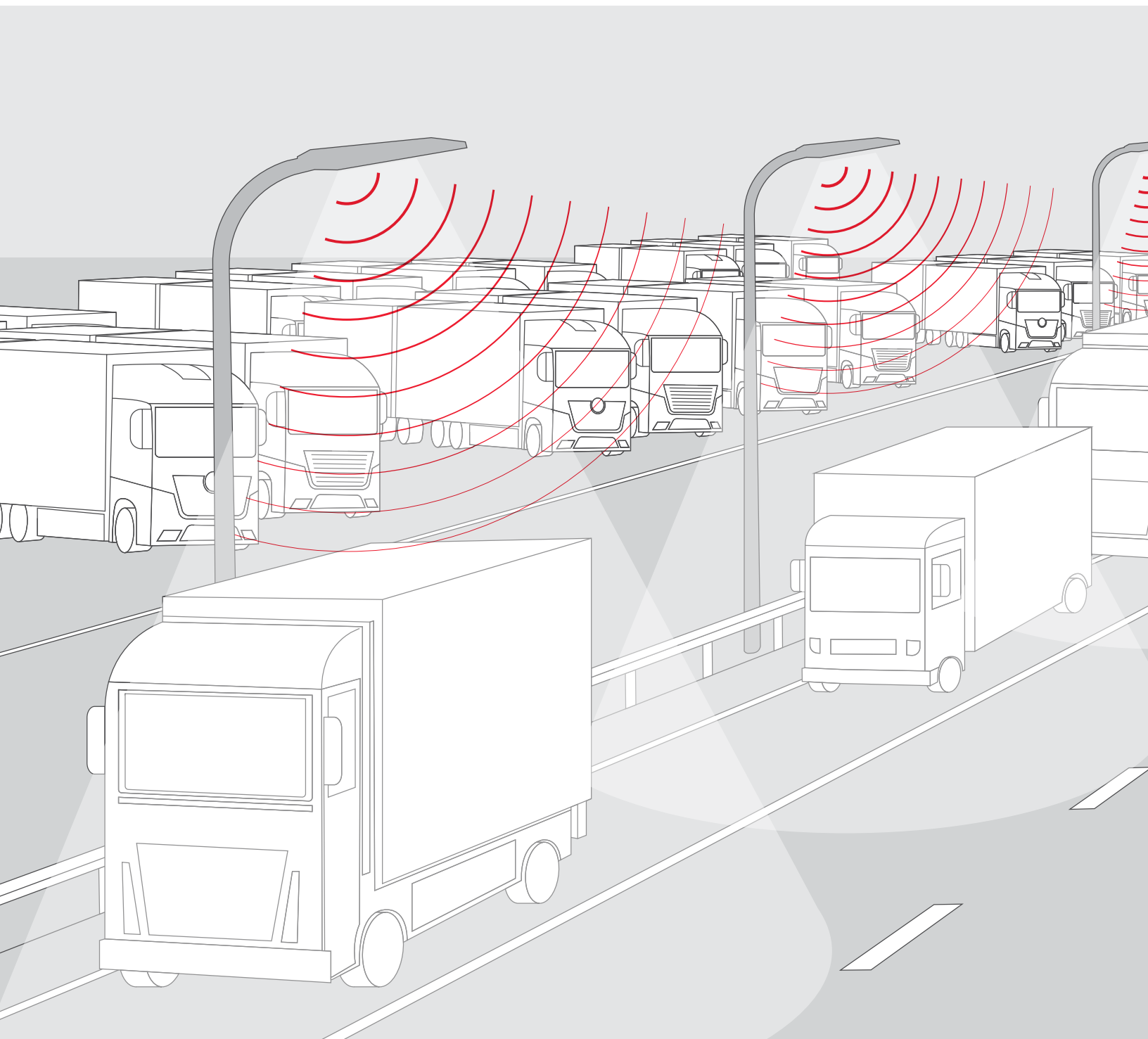

Project: Industrial park, Berlin-Schönefeld, Germany

Our solution: Streetlight SL 21 with Smart Interface,

SITECO Connect 11 including radar- and PIR motion detectors

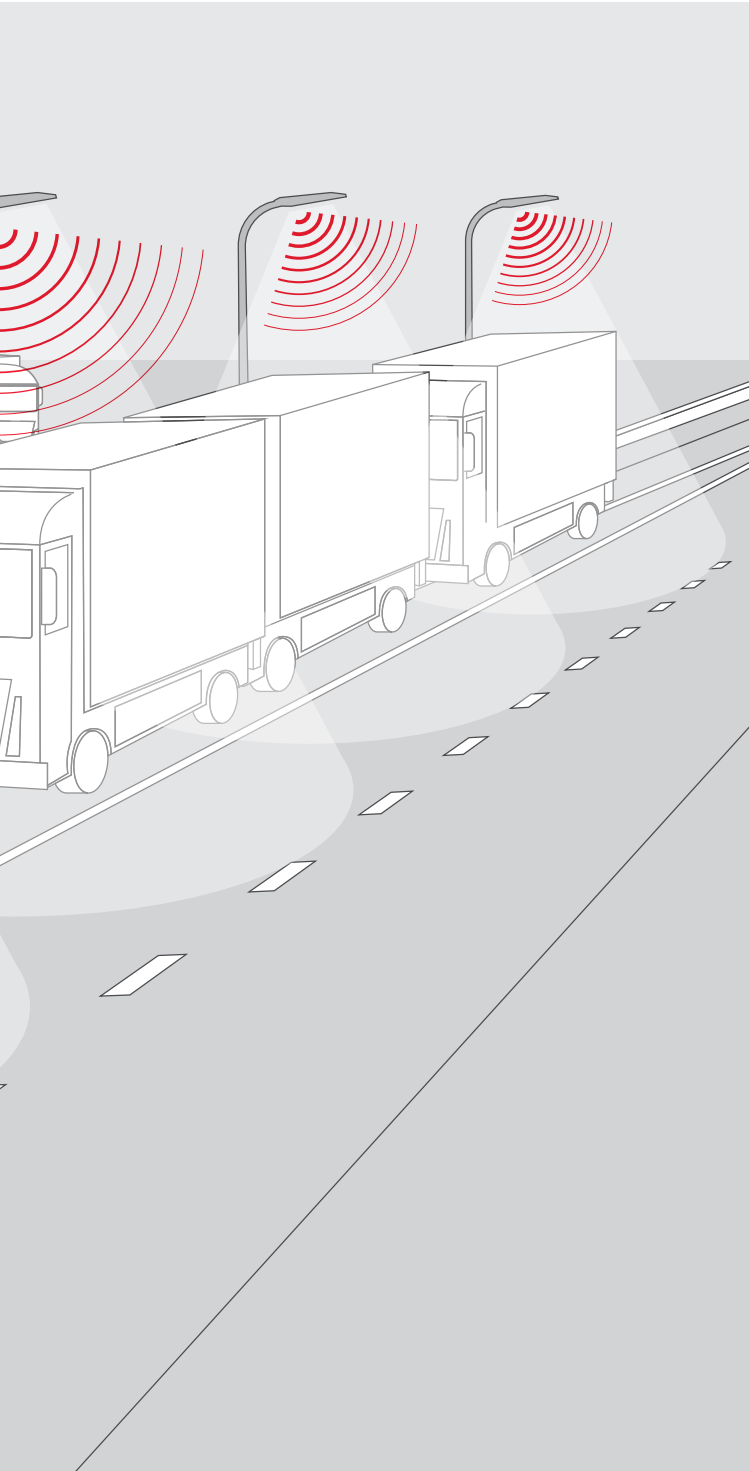

Night light for tired truck drivers.

- Demand-oriented light for commercial areas with waiting and rest zones for truck drivers
- Radio networked motion detectors respond within milliseconds according to demand and traffic level
- High sense of security without dark corners
- Simultaneously optimal rest situation for truck drivers with dimmed light
- Individual adaptation of switching and dimming values by the customer
- Monitoring of the system via email and SMS notifications

SITECO Services

All-round, worry-free service provided by our strong partner network.

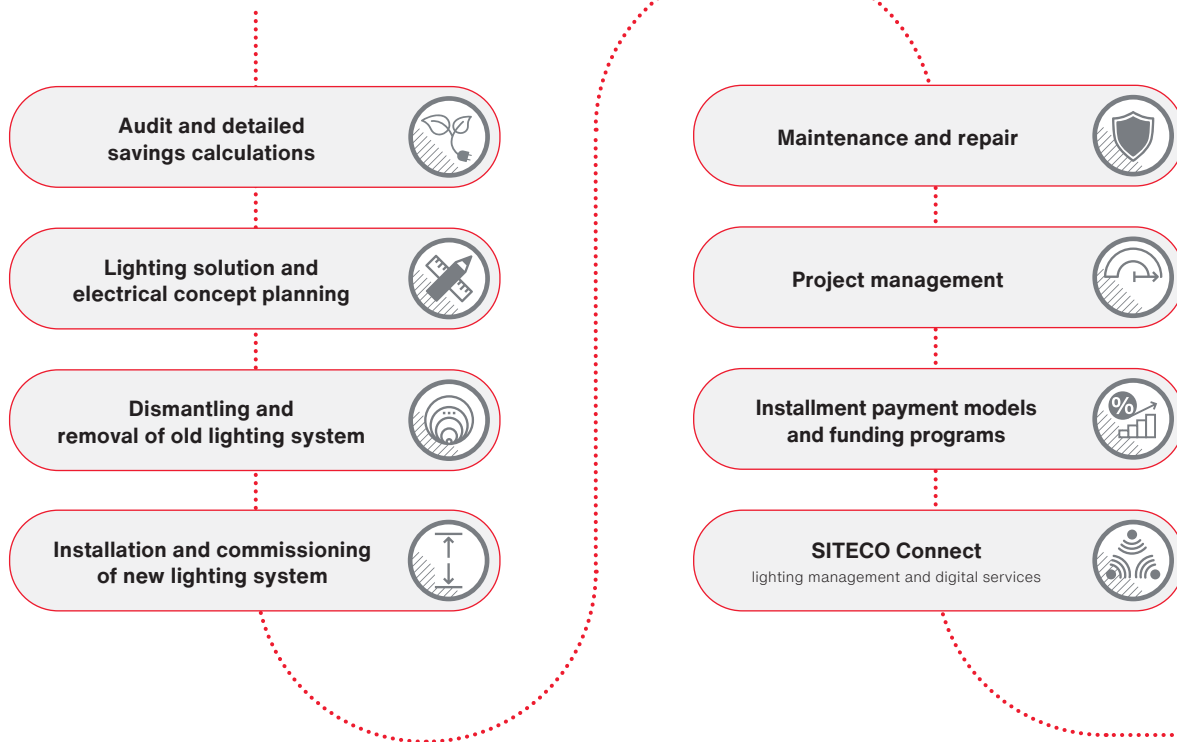

Our service model provides you with turnkey solutions from a single source – from planning and installation phases through to maintenance and financing. The choice is yours: simply purchase the lighting system by itself or select our all-in-one package.

SITECO is the company to partner with to plan and design your lighting solution.

Contact.

Siteco GmbH

Georg-Simon-Ohm-Str. 50
83301 Traunreut, Germany
Tel. +49 8669 330
info@siteco.com

Technical support

Tel. +49 8669 336 70
solution.support@siteco.de

siteco.com